

## ■ BUTTON OPERATION AND SETUP ■

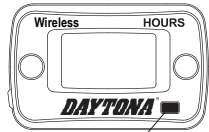

(SET) button

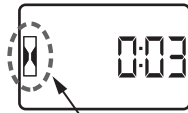

hour icon  
(Flashes only when operated.)

### ■ Icon instructions



One click : Press (SET) button



2sec : Hold down (SET) button for 2 seconds.

### POWER ON

To turn on the unit power, hold down (SET) button for two seconds.

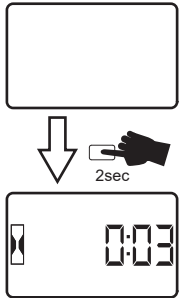

### POWER OFF

To turn off the unit power, hold down (SET) button for two seconds.

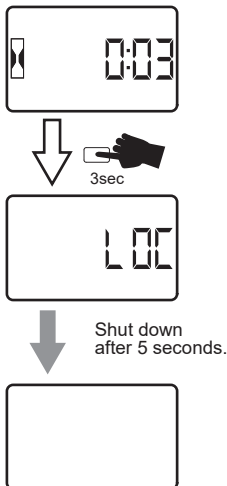

## ■ CAUTION ■

### Battery

This wireless hour meter is inner battery driven. Average battery life is 4 years when used 24h. The battery cannot be exchanged. Please don't disassemble.

### Installation

This wireless hour meter can be mounted using the supplied double sided tape or 2 screws(M3x10mm). Double sided tape is recommended. When mount with 2 screws, look for flat space and never mount on gasoline tank, engine crank case nor oil tank etc, also avoid area where receives too much vibration.

## SETUP

※When no action for 3 sec, goes' back to NOMAL DISPLAY.

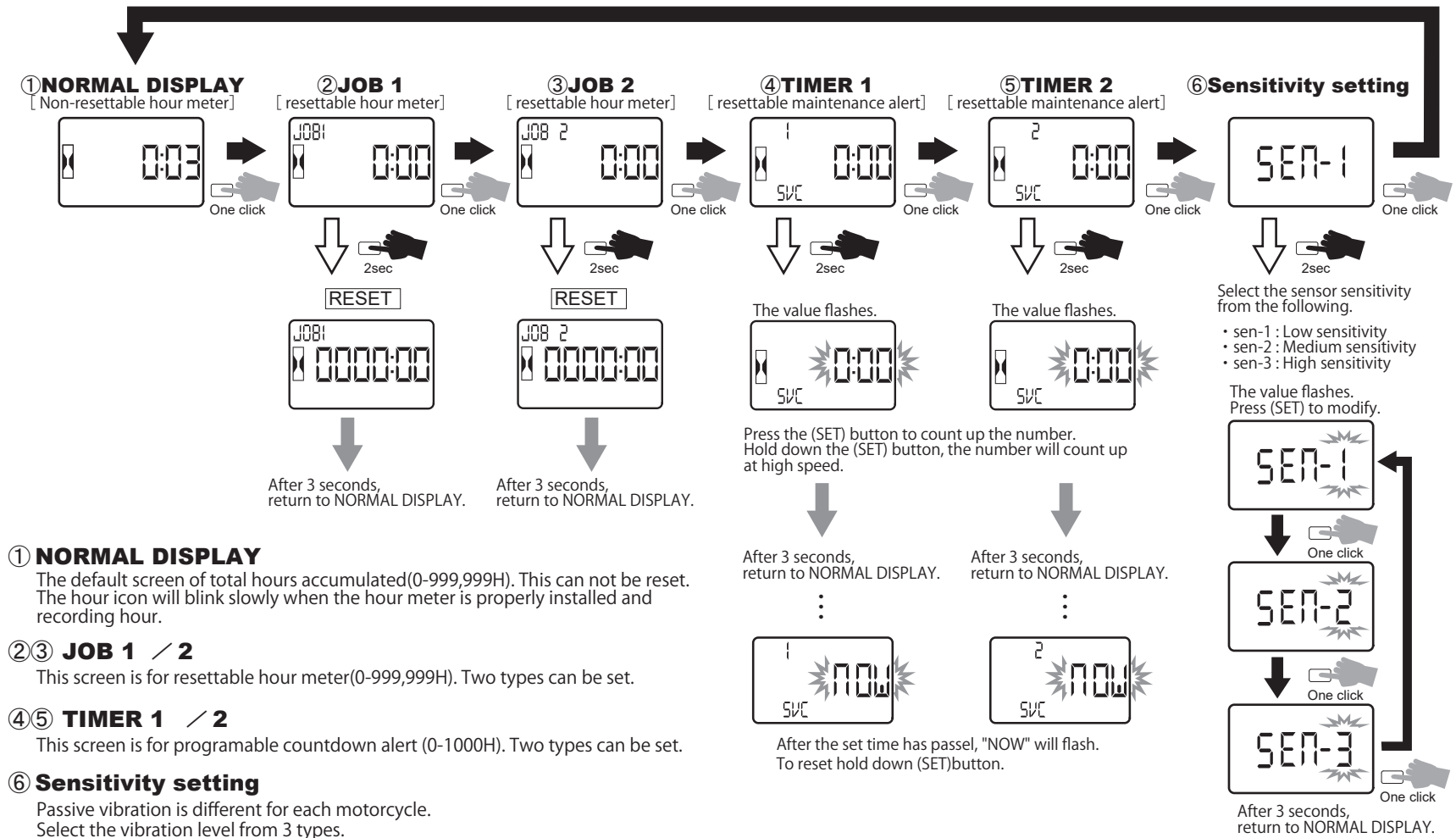

### ① NORMAL DISPLAY

The default screen of total hours accumulated(0-999,999H). This can not be reset. The hour icon will blink slowly when the hour meter is properly installed and recording hour.

### ②③ JOB 1 / 2

This screen is for resettable hour meter(0-999,999H). Two types can be set.

### ④⑤ TIMER 1 / 2

This screen is for programmable countdown alert (0-1000H). Two types can be set.

### ⑥ Sensitivity setting

Passive vibration is different for each motorcycle. Select the vibration level from 3 types.