





STANDARD BLACK HYPERCHARGER — BOLT

9428

THANK YOU FOR CHOOSING KÜRYAKYN!

PROTECT YOURSELF AND OTHERS FROM POSSIBLE INJURY AND PROPERTY DAMAGE OR LOSS. PAY CLOSE ATTENTION TO ALL INSTRUCTIONS, WARNINGS, CAUTIONS, AND NOTICES REGARDING THE INSTALLATION, USE, AND CARE OF THIS PRODUCT.

	THIS INDICATION ALERTS YOU TO THE FACT THAT IGNORING THE CONTENTS DESCRIBED HEREIN CAN RESULT IN POTENTIAL DEATH OR SERIOUS INJURY.
	This indication alerts you to the fact that ignoring the contents described herein can result in minor or moderate potential injury.
	This indication alerts you to the fact that ignoring the contents described herein may negatively affect product performance and functionality or damage the product itself or the product to which it is being attached.

MAKE SURE THE FOLLOWING PARTS HAVE BEEN INCLUDED IN THE KIT:

- 1 Standard Hypercharger Assembly
- 1 Gasket and Hose Kit containing (#5 Late Hyper Kit):
 - 1 Vacuum Hose
 - 1 Straight Hose Fitting
 - 2 Gaskets
 - 1 Adhesive Gasket
 - 3 1/4"-20 X 5/8" Socket Head Cap Screws
 - 1 Instructions for K&N® Filter
 - 1 K&N® Filter Sticker
- 1 Air Cleaner Mount Kit:
 - 1 Air Cleaner Adapter
 - 1 Rubber Inlet Flow-Plate
 - 1 Support Bracket
 - 1 Hardware Kit containing:
 - 1 M6 X 1.0 X 30MM Socket Head Cap Screw
 - 1 M6 Flat Washer
 - 2 M5 X 0.8 X 14MM Socket Head Cap Screws
 - 2 M5 Split Lock Washers
- 1 1/2" Barbed Elbow Hose Fitting
- 1 Installation Instructions

TOOLS SUGGESTED:

Phillips screwdriver, set of metric hex wrenches, set of metric sockets and ratchet, set of metric combination wrenches, set of standard hex wrenches, set of standard combination wrenches

NOTICE

These installation instructions contain important information. Ensure that the end user receives this copy and is aware of its importance for future reference.

If the OEM exhaust system is replaced or altered (in addition to replacing the air cleaner), then install Kuryakyn P/N 9218 Wild Things Fuel Controller to prevent a "lean" fuel/air mixture that can result in over heating leading to engine damage.

CUSTOMER SERVICE

877.370.3604 (toll free)

INSTALLATION QUESTIONS

techsupport@kuryakyn.com
or call 715.247.2983

LIMITED WARRANTY

Kuryakyn warrants that any Kuryakyn products sold hereunder, shall be free of defects in materials and workmanship for a period of one (1) year from the date of purchase by the consumer excepting the following provisions:

- Kuryakyn shall have no obligation in the event the customer is unable to provide a receipt showing the date the customer purchased the product(s).
 - The product must be properly installed, maintained and operated under normal conditions.
 - Kuryakyn makes no warranty, expressed or implied, with respect to any gold plated products.
 - Kuryakyn shall not be liable for any consequential and incidental damages, including labor and paint, resulting from failure of a Kuryakyn product, failure to deliver, delay in delivery, delivery in nonconforming condition, or for any breach of contract or duty between Kuryakyn and a customer.
- Kuryakyn products are often intended for use in specific applications. Kuryakyn makes no warranty if a Kuryakyn product is used in applications other than intended.
- Kuryakyn electrical products are warranted for one (1) year from the date of purchase by the consumer. L.E.D.'S contained in components of Kuryakyn products will be warranted for defects in materials and workmanship for 3 years from the date of purchase where as all other components shall be warranted for one(1) year. This includes, but is not limited to; control modules, wiring, chrome & other components.
- Kuryakyn makes no warranty of any kind in regard to other manufacturer's products distributed by Kuryakyn. Kuryakyn will pass on all warranties made by the manufacturer and where possible, will expedite the claim on behalf of the customer, but ultimately, responsibility for disposition of the warranty claim lies with the manufacturer.

ABOUT OUR CATALOG

For purchasing Kuryakyn® products, you can receive a complete catalog free of charge. Send the Proof-of-Purchase below with your address to: Kuryakyn
454 County Road V V
Somerset, WI 54025-9031
Please indicate either Accessories Catalog for Harley-Davidson® or GL & Metric Cruisers.

Be sure to ask your local dealer about other Kuryakyn® products, the motorcycle parts and accessories designed for riders by riders.

©2005 Kuryakyn USA® All Rights reserved.





YOU WILL BE WORKING AROUND THE ENGINE AND EXHAUST SYSTEM DURING INSTALLATION. ENSURE THAT THE ENGINE AND EXHAUST SYSTEM HAVE FULLY COOLED TO PREVENT INJURY.



Working around the sharp edges of the cylinder-head fins exposes your hands to injury. Wear protective gloves to prevent serious injury.

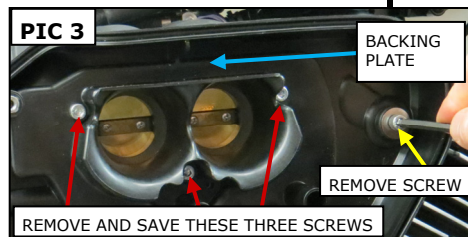
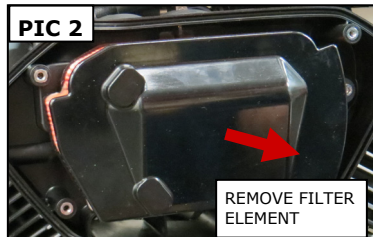
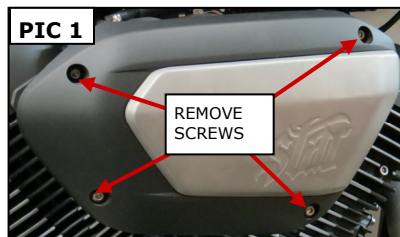

STEP 1 Read and understand all steps in the instructions before starting the installation. Park the motorcycle on a hard, level surface and turn off the ignition. Allow the engine and exhaust system to cool.

STEP 2 Refer to **PIC 1 through 3**. Remove existing air cleaner cover, filter element, and backing plate; save the three screws shown in **PIC 3**.

STEP 3 Refer to **PIC 4**. Disconnect the breather hose from the backside of the backing plate. Ensure the spring clip remains on the hose; it will be reused. Set the backing plate aside, it will not be reused.

STEP 4 Refer to **PIC 4**. Remove the lower screw from the timing chain tensioner housing. Set the screw aside; it will not be reused.

STEP 5 Refer to **PIC 4**. Remove the front Phillips head screw from the bottom of the throttle body. Set the screw aside; it will not be reused.

STEP 6 Locate the included Mounting Bracket. Secure the Mounting Bracket to the underside of the throttle body with an included M5 X 0.8 X 14MM Socket Head Cap Screw and M5 Split Lock Washer. Leave the Screw finger tight for now.

NOTE: Remove one Phillips head screw at a time to prevent dislodging the plate and O-ring it secures.

STEP 7 Remove the rear screw from the underside of the throttle body. Refer to **PIC 5**. Swing the Mounting Bracket in until the holes align; secure the Bracket with the other M5 Screw and Lock Washer. Leave the Screw snug for now.

STEP 8 Align the Mounting Bracket slot with the hole in the timing chain tensioner housing; thread the included M6 Socket Head Cap Screw with Flat Washer through the slot and into the tensioner housing. Leave the Screw snug for now.

STEP 9 Tighten the two M5 Screws from **STEP 6 and 7**. **Do NOT over tighten the Screws.** Tighten the M6 Screw from **STEP 8**.

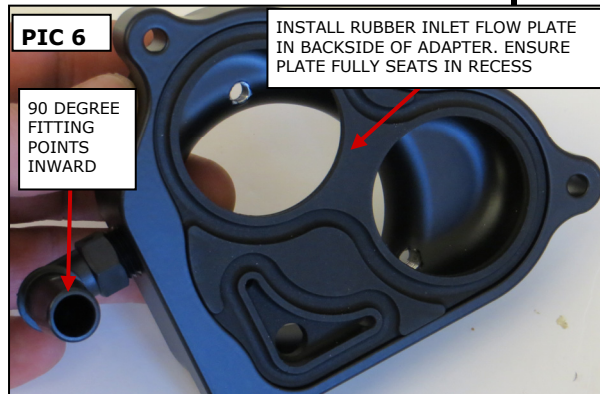
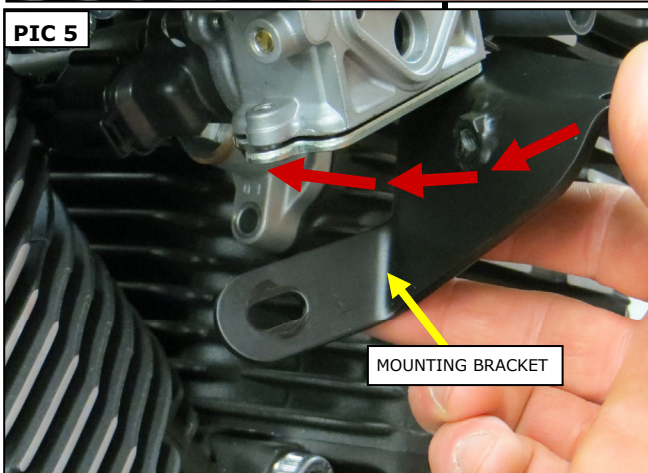
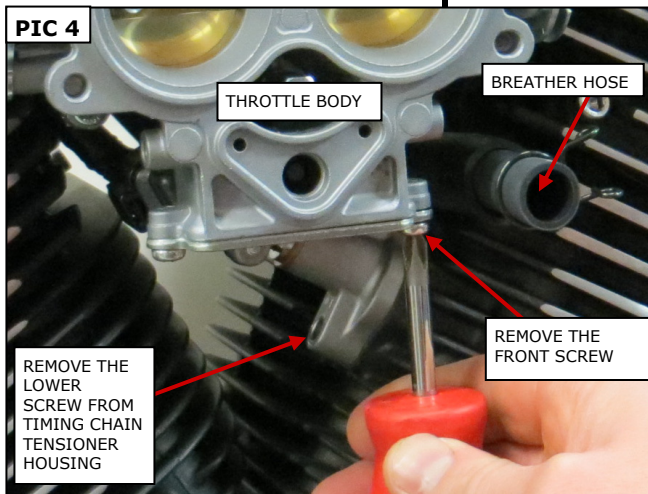

-cont.-

STEP 10

Refer to **PIC 6 on PAGE 2**. Thread the included 1/2" Barbed Elbow Hose Fitting into the included Air Cleaner Adapter. Ensure the Fitting points inward when installed.

STEP 11

Refer to **PIC 6 on PAGE 2**. Install the included Rubber Inlet Flow Plate in the Adapter as shown.

STEP 12

Refer to **PIC 7**. Hold the Adapter assembly up to the throttle body; attach the breather hose to the 1/2" Elbow Fitting and secure it with the hose clip.

STEP 13

Position the Adapter so that the Rubber Plate interlocks with the flange on the throttle body.

STEP 14

Refer to **PIC 7**. Secure the Adapter to the throttle body with the three OEM screws removed in **STEP 2**. Leave the screws loose until all three have been started, then tighten.

STEP 15

Refer to **PIC 7**. Remove the adhesive backing from the included Adhesive Gasket, align the holes, and install it on the Adapter as shown.

STEP 16

Refer to **PIC 8**. On top of the throttle body, remove the cap and connect the included Vacuum Hose to the vacuum nipple.

STEP 17

Locate the included Hypercharger. Refer to **PIC 9**. Remove the four Screws securing the Trap Door to the Hypercharger; set the Screws and Trap Door aside for now.

STEP 18

Attach the Hypercharger to the throttle body with the included 1/4"-20 X 5/8" Socket Head Cap Screws. Tighten the screws evenly. **DO NOT** over-tighten the screws.

Refer to **PICS 9 and 10**. **DO NOT** place a screw through the vent hole at the 10-o'clock position.

STEP 19

Route the Vacuum Hose toward the front of the Hypercharger (ensure it routes away from moving parts, extreme heat, and vibration).

Connect the Vacuum Hose to the Hypercharger Vacuum Nipple located on the backside.

STEP 20

Refer to **PIC 10**. Securely snap the included Velocity Ring to the inside of the Hypercharger. Ensure that the hole in the Velocity Ring aligns with the vent hole (10 o'clock position).

STEP 21

Reinstall the Trap Door and four Screws.

STEP 22

Ensure the tightness of all related fasteners, check for hose clearance and check throttle for correct operation, making sure it returns properly, **BEFORE** starting the bike.

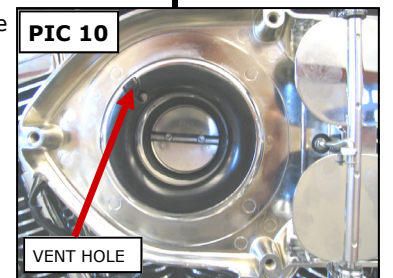
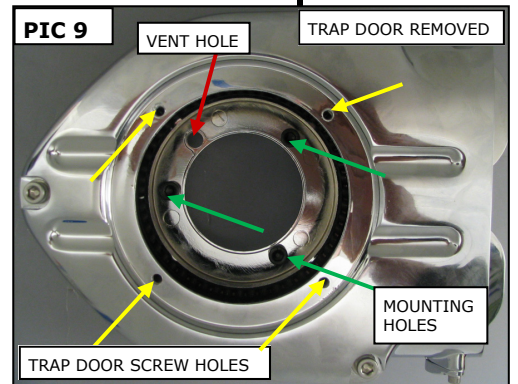
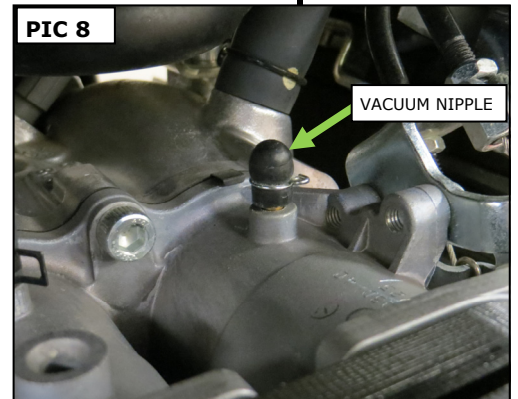
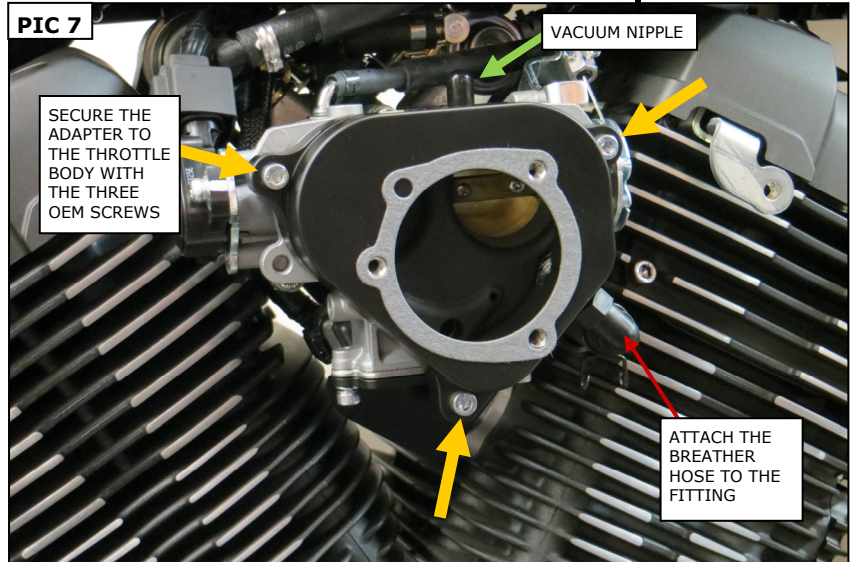

NOTICE

Some high performance air cleaners extend beyond the OEM unit to achieve smoother air flow and better performance. Riding position may be affected, so it is important to familiarize yourself with the new riding position.

NOTICE

It is the end user's responsibility to ensure that all of the fasteners (including pre-assembled) are tightened before operation of the motorcycle. Kuryakyn will not provide warranty coverage on products or components lost or damaged due to improper installation or lack of maintenance. Periodic inspection and maintenance are required on all fasteners.

Ride On!