



INSTALLATION

HYPERCHARGER AIR FILTER KIT

9767

PARTS INCLUDED

- 1 Chrome Hypercharger Assembly
- 1 Adapter/Breather Kit Including:
 - 2 90 Degree Barbed Fittings
 - 1 5/32" x 16" Rubber Hose
 - 6 4" Cable Ties
 - 3 1/4"-20 x 5/8" Socket Head Cap Screws
 - 3 1/4"-20 x 7/8" Socket Head Cap Screws
 - 1 Breather/Adapter
 - 1 O-Ring
 - 1 Gasket with Adhesive
 - 2 O.E. Style Twin Cam Breather Hoses
 - 2 O.E. Style Twin Cam Breather Bolts
- 1 Installation Instructions

Please read and understand entire instructions before starting installation.

THANK YOU FOR CHOOSING KÜRYAKYN!

IN ORDER TO PROTECT YOU AND OTHERS FROM POSSIBLE INJURY AND/OR PROPERTY DAMAGE OR LOSS, PLEASE PAY CLOSE ATTENTION TO ALL INSTRUCTIONS, WARNINGS, CAUTIONS AND NOTICES REGARDING THE USE AND CARE OF THIS PRODUCT.

WARNING

THIS INDICATION ALERTS YOU TO THE FACT THAT IGNORING THE CONTENTS DESCRIBED HEREIN CAN RESULT IN POTENTIAL DEATH OR SERIOUS INJURY.

NOTICE

This indication alerts you to the fact that ignoring the contents described herein may negatively affect product performance and functionality.

NOTICE

IF INSTALLING THIS PRODUCT FOR ANOTHER PARTY, PLEASE MAKE SURE THEY RECEIVE THIS COPY OF THE INSTALLATION INSTRUCTIONS SO THEY ARE AWARE OF THE IMPORTANT INFORMATION CONTAINED IN THEM.

TOOLS SUGGESTED

Set of Hex Wrenches, Socket Set with Ratchet, Needle Nose Pliers, Side Cutter

STRICTLY OBSERVE THE FOLLOWING GUIDELINES IN ORDER TO USE THE PRODUCT PROPERLY AND AVOID POTENTIALLY DANGEROUS ACCIDENTS.

STEP 1

Read and understand all steps in the instructions before starting the installation. Park the motorcycle on a hard, level surface and turn off the ignition. Let cool.

WARNING

YOU WILL BE WORKING AROUND THE ENGINE AND EXHAUST SYSTEM DURING INSTALLATION. ENSURE THAT THE ENGINE AND EXHAUST SYSTEM HAVE FULLY COOLED TO PREVENT INJURY.

-cont.-

9767-24HD-0313



CUSTOMER SERVICE

877.370.3604 (toll free)

INSTALLATION QUESTIONS

techsupport@kuryakyn.com
or call 715.247.2983

LIMITED WARRANTY

Kuryakyn warrants that any Kuryakyn products sold hereunder, shall be free of defects in materials and workmanship for a period of one (1) year from the date of purchase by the consumer excepting the following provisions:

- Kuryakyn shall have no obligation in the event the customer is unable to provide a receipt showing the date the customer purchased the product(s).
 - The product must be properly installed, maintained and operated under normal conditions.
 - Kuryakyn makes no warranty, expressed or implied, with respect to any gold plated products.
 - Kuryakyn shall not be liable for any consequential and incidental damages, including labor and paint, resulting from failure of a Kuryakyn product, failure to deliver, delay in delivery, delivery in nonconforming condition, or for any breach of contract or duty between Kuryakyn and a customer.

• Kuryakyn products are often intended for use in specific applications. Kuryakyn makes no warranty if a Kuryakyn product is used in applications other than intended.

• Kuryakyn electrical products are warranted for one (1) year from the date of purchase by the consumer. L.E.D.'S contained in components of Kuryakyn products will be warranted for defects in materials and workmanship for 3 years from the date of purchase where as all other components shall be warranted for one(1) year. This includes, but is not limited to; control modules, wiring, chrome & other components.

• Kuryakyn makes no warranty of any kind in regard to other manufacturer's products distributed by Kuryakyn. Kuryakyn will pass on all warranties made by the manufacturer and where possible, will expedite the claim on behalf of the customer, but ultimately, responsibility for disposition of the warranty claim lies with the manufacturer.

ABOUT OUR CATALOG

For purchasing Kuryakyn® products, you can receive a complete catalog free of charge.

Send the Proof-of-Purchase below with your address to: Kuryakyn, P.O. Box 339, Somerset, WI 54025.

Please indicate either Accessories Catalog for Harley-Davidson® or GL & Metric Cruisers.

Be sure to ask your local dealer about other Kuryakyn® products, the motorcycle parts and accessories designed for riders.

©2005 Kuryakyn USA® All Rights reserved.

kuryakyn.com



WARNING

A FACTORY SERVICE MANUAL WILL BE HELPFUL IN PERFORMING THIS INSTALLATION. DO NOT ATTEMPT TO PERFORM THIS INSTALLATION IF YOU ARE NOT CONFIDENT IN YOUR ABILITY TO COMPLETE ALL OF THE STEPS IN THE PROCEDURE; CONSULT A TRAINED TECHNICIAN. IMPROPER INSTALLATION COULD RESULT IN SERIOUS INJURY OR DEATH.

NOTICE

Some of our high performance air cleaners extend beyond the stock/OEM unit to achieve smoother air flow and better performance. Riding position may be affected, so it is important to familiarize yourself with the new riding position.

NOTICE

Proper tuning is important. We recommend fuel injected bikes should be tuned with a TTS Master Tune tuning system (calibrations available at www.kuryakyn.com), or by an experienced tuner, on a dyno, with an exhaust gas analyzer. Lean conditions and/or retarded ignition timing will cause high exhaust temperatures and discolor chrome exhaust.

STEP 2 Remove the stock air cleaner assembly, mounting hardware and hoses.

STEP 3 Remove the two OEM breather bolts that secure the EFI support bracket to the heads; they will not be reused.

STEP 4 Remove the screws that secure the bracket to the fuel induction module shown in FIG 1. Set the screws aside for now; they will be used to re-install the bracket.

STEP 5 Referring to FIG 1, remove the cap from the fuel induction module vacuum nipple.

STEP 6 Install the 5/32" x 16" Rubber Hose on the nipple. Secure with an included cable tie, trimming off any of the excess cable tie. Route the hose down along the front side of the fuel induction module.

STEP 7 Reinstall the support bracket on the fuel induction module using the screws removed in STEP 4.

STEP 8 Secure the bracket to the heads using the included O.E. style breather bolts from the hardware kit and tighten them.

STEP 9 Install the 90-degree barbed fittings into the breather adapter so that they face towards the engine at a slight angle. PIC 1

STEP 10 Install the O-Ring in the groove on the backside of the breather adapter as shown in PIC 1.

STEP 11 Place the breather adapter on the fuel induction module, so that the O-Ring is facing the fuel module and the 90-degree fittings are in the upright position as shown in PIC 3 (next page). Secure using three 1/4-20 x 7/8" socket head cap screws.

-cont.-

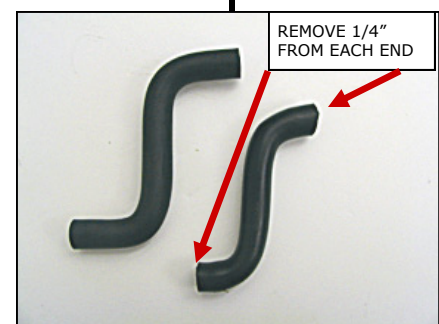
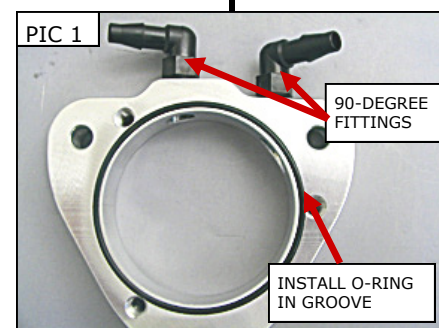
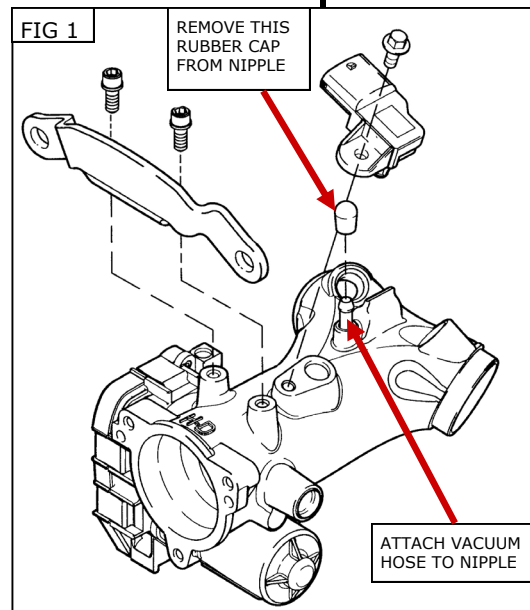

STEP 12 Modify **ONE** of the supplied breather hoses by removing 1/4" from each end of the hose as shown in PIC 2.

STEP 13 Install the modified hose between the rear breather bolt and the rear 90-degree barbed fitting. Install the unmodified breather hose between the front breather bolt and the front 90-degree barbed fitting. Secure the ends of both hoses with the supplied cable ties; snip the excess ends of the cables ties after installation. PIC 3

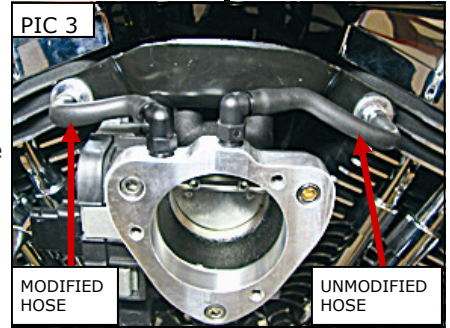

STEP 14 Remove the trap door from the Hypercharger, set the fasteners, washers and gasket aside; they will be needed to reinstall the trap door.

STEP 15 Insert three 1/4"-20 x 5/8" socket head cap screws in the proper holes in the Hypercharger as shown in PIC 4.

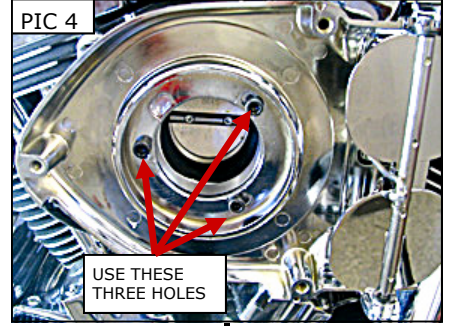

STEP 16 Remove the adhesive backing from the gasket, and install on the backside of the Hypercharger, over the protruding fasteners.

STEP 17 Place the Hypercharger onto the breather adapter, rotate to the desired position, making sure that there is proper clearance for the Hypercharger, and secure the fasteners.

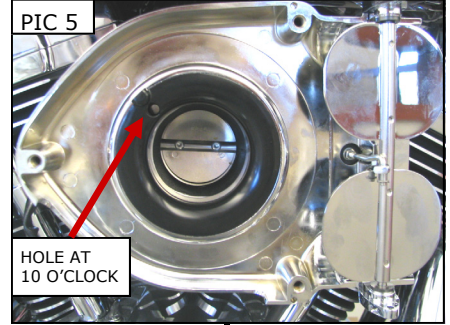

NOTICE CHECK FOR CLEARANCE BETWEEN THE AIR FILTER AND THE TANK WHEN THE BIKE IS RUNNING AND UNDER TORQUE.

STEP 18 Install the dual velocity ring with the hole in the ten o'clock position shown in PIC 5.

STEP 19 Reinstall the trap door using the gasket, screws, and washers that were removed in Step 14.

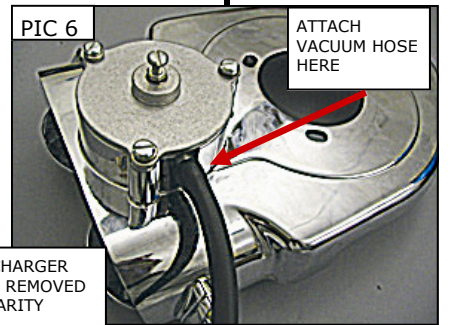

STEP 20 Connect the vacuum line to the nipple on the bottom of the Hypercharger vacuum pod as shown in PIC 6. (You may choose to trim the vacuum hose so that there is not so much excess hose.)

STEP 21 **Double check the tightness of all related fasteners, check for hose clearance and check throttle for correct operation, making sure it returns properly, before starting bike.**

WARNING ROTATE THROTTLE AND CHECK THAT IT MOVES FREELY AND RETURNS TO CLOSED BEFORE STARTING BIKE. FAILURE OF THE THROTTLE TO RETURN COULD RESULT IN LOSS OF CONTROL CAUSING SERIOUS INJURY OR DEATH.

NOTICE It is the installer's responsibility to ensure that all of the fasteners (including pre-assembled) are tightened before operation of the motorcycle. Küryakyn will not provide warranty coverage on products or components lost due to improper installation or lack of maintenance. Periodic inspection and maintenance are required on all fasteners.

Ride On!